

PERMIT

CITY OF NAPOLEON - BUILDING DEPARTMENT

255 West Riverview Avenue, Napoleon, Ohio 43545 - 419-592-4010

Permit No. 02420 Issued 8-21-91
date

Job Location 1106 Westchester
address

Lot _____
sub-div or legal discript

Issued By Brent N. Damman
building official

Owner Phil Baatz
name tel.

Address 1106 Westchester

Agent Creighton Electric 237-2223
builder-eng.-etc. tel.

Address Rt. 1, Fayette, Ohio 43521

Description of Use Residential

Residential 1
no. dwelling units

Commercial _____ Industrial _____

New XX Add'n. _____ Alter _____ Remodel _____

Mixed Occupancy _____

Change of Occupancy _____

Estimated Cost \$ _____

FEES	BASE	PLUS	TOTAL
<input type="checkbox"/> BUILDING			
<input checked="" type="checkbox"/> ELECTRICAL	\$15.00	\$81.00	\$96.00
<input type="checkbox"/> PLUMBING			
<input type="checkbox"/> MECHANICAL			
<input type="checkbox"/> DEMOLITION			
<input type="checkbox"/> ZONING			
<input type="checkbox"/> SIGN			
<input type="checkbox"/> WATER TAP			
SEW. INSP.			
SEWER TAP			
TEMP. WATER			
TEMP. ELECT.			
ADDITIONAL PLAN REVIEW	Struct. _____ hrs	Elect. _____ hrs	
TOTAL FEES.....			\$96.00
LESS MIN. FEES PAID <u>8-21-91</u> <small>date</small>			\$96.00
BALANCE DUE.....			\$ 0.00

ZONING INFORMATION

district	lot dimensions	area	front yd	side yds	rear yd
max hgt	no pkg spaces	no ldg spaces	max cover	petition or appeal req'd	date appr

WORK INFORMATION:

Size: Length _____ Width _____ Stories _____ Ground Floor Area _____

Height _____ Building Volume (for demo. permit) _____ cu. ft.

Electrical: _____
brief description

Plumbing: _____
brief description

Mechanical: _____
brief description

Sign: _____ Dimensions _____ Sign Area _____

Additional Information: _____

Date 8-21-91 Applicant Signature *Phil Baatz* owner-agent

PAID
AUG 21 1991
CITY OF NAPOLEON

INSPECTION RECORD

	UNDERGROUND			ROUGH-IN						FINAL		
	Type	Date	By	Type	Date	By	Type	Date	By	Type	Date	By
PLUMBING	Building Drains			Drainage, Waste & Vent Piping			Indirect Waste			Drainage, Waste & Vent Piping		
	Water Piping									Backflow Prevention		
	Building Sewer			Water Piping			Condensate Lines			Water Heater		
	Sewer Connection									FINAL APPROVAL		
MECHANICAL	Refrigerant Piping			Refrigerant Piping			Chimney(s)			Grease Exhaust System		
				Duct Furnace(s)			Fire Dampers			Air Cond. Unit(s)		
	Ducts/Plenums			Ducts/Plenums			<input type="checkbox"/> Radiant Htr(s) <input type="checkbox"/> Unit Htr(s)			Refrigeration Equipment		
				Duct Insulation			Pool Heater			Furnace(s)		
			Combustion Products Vents			Ventilation <input type="checkbox"/> Supply <input type="checkbox"/> Exhst.				FINAL APPROVAL		
ELECTRICAL	Conduits & or Cable			Conduits/ Cable			<input type="checkbox"/> Range <input type="checkbox"/> Dryer			Temp Service Temp Lighting		
	Grounding & or Bonding			Rough Wiring	8/30	BD	<input type="checkbox"/> Generator(s) <input type="checkbox"/> Motors			Fixtures Lampholders		
	Floor Ducts Raceways			Service Panel Switchboard	8/30	BD	<input type="checkbox"/> Water Htr <input type="checkbox"/> Welder			Signs		
	Service Conduit			Busways Ducts	0		<input type="checkbox"/> Heaters <input type="checkbox"/> Heat Cable			Electric Mtr. Clearance	8/30	BD
	Temporary Power Pole			Subpanels			<input type="checkbox"/> Duct Htr(s) <input type="checkbox"/> Furnace(s)			FINAL APPROVAL	8/12	BD
BUILDING	Location, Set-backs, Esmt(s)			Exterior Wall Construction			Roof Covering Roof Drainage			Smoke Detector		
	Excavation						Exterior Lath			Demolition (sewer cap)		
	Footings & Reinforcing						<input type="checkbox"/> Interior Lath <input type="checkbox"/> Wallboard					
	Floor Slab			Interior Wall Construction			Fire Wall(s)			Building or Structure		
	Foundation Walls			Columns & Supports			Fireplace Chimney					
	Sub-soil Drain			Crawl Space <input type="checkbox"/> Vent <input type="checkbox"/> Access			Attic <input type="checkbox"/> Vent <input type="checkbox"/> Access					
	Piles			Floor System(s)						FINAL APPROVAL BLDG. DEPT.		
			Roof System			Special Insp Reports Rec'd			Certificate of Occupancy Issued			
ADDITIONAL	INSPECTIONS, CORRECTIONS, ETC.						INSPECTIONS, CORRECTIONS, ETC.					

APPLICATION
for
RESIDENTIAL BUILDING, ELECTRICAL, PLUMBING, MECHANICAL, PERMITS and DEMOLITION PERMIT
from the
CITY OF NAPOLEON - BUILDING DEPARTMENT
255 West Riverview Ave. Napoleon, Ohio 43545 Pn. 419-592-4010

Entry No. _____

Permit No. 02420 Issued August 21 1991

Job Location 1106 Westchester

Lot _____ sub-div. or legal disc. _____

Issued By BND building official

Owner Phil Baatz Pn _____

Address 1106 Westchester

Agent Creighton Electric Pn 237-2223

Address Fayette OH Rt 1 43521

Description of Use _____

Residential _____ no. dwelling units _____

Commercial _____ Industrial _____

New Add'n. _____ Alter _____ Remodel _____

Mixed Occupancy _____

Change of Occupancy _____

Estimated Cost \$ _____

ZONING INFORMATION

district	lot dimensions	area	front yd	side yds.	rear yd
max hgt	no pkg spaces	no ldg spaces	max cover	petition or appeal req'd.	date appr

WORK INFORMATION:

BUILDING: Garage Fl. Area _____ Basement Fl. Area _____ Second Floor Area _____
Size: Length _____ Width _____ Stories _____ Ground Floor Area _____
Height _____ Building Value (for deas. permit) _____ cu. ft.

Description of Work: _____

Ch. Permits Req.	Base	Fees Plus	Total
<input type="checkbox"/> Building			
<input checked="" type="checkbox"/> Electrical	<u>15.00</u>	<u>81.00</u>	<u>96.00</u>
<input type="checkbox"/> Plumbing			
<input type="checkbox"/> Mechanical			
<input type="checkbox"/> Demolition			
<input type="checkbox"/> Zoning			
<input type="checkbox"/> Sign			
<input type="checkbox"/> Water tap			
<input type="checkbox"/> Sewer Tap			
<input type="checkbox"/> Temp. Water			
<input type="checkbox"/> Temp. Elec.			
Additional plan review	struc. _____ hrs	Elect. _____ hrs	
Total Fees.....		<u>96.00</u>	
Less Min. Fees Pd.			
Balance Due.....			

PAID

AUG 21 1991

CITY OF NAPOLEON

Continue on Back Side for Electrical, Plumbing and Mechanical and other Information;

WATER TAPPING PERMIT

issued by

The Napoleon Water Distribution Department

255 West Riverview Ave. Napoleon, Ohio 43545 Ph. 592-4010

Entry No.

W-589-91

Permit No.

~~589-91~~

Issued

7-22-91

Received of

Phil Baatz

(\$ 375) .00

(Charge for tapping permit to supply water service to) Lot No.

22

Sub Div.

Gerken Hoeftel

Street No.

1106 Westchester

Tap Size

1

Cost \$

375

.00 Plumber

Whitmer PTH

Date completed

Approved by

water distribution dept.

finance director

Name

Size of tap

Date

Street and No.

Old Tap No.

New Tap No.

Size and Kind of Main

Location of Main

Depth of Main

Distance from Hydrant/Valve

Distance to Curb Stop from Corp.

.st.

.st.

.st.

.st.

.st.

WATER TAPPING PERMIT

issued by

The Napoleon Water Distribution Department

255 West Riverview Ave. Napoleon, Ohio 43545 Pn. 592-4010

Entry No.

Permit No. ~~0-2343~~ ^{W-589-91}

Issued 7-22-91

Received of Phil Baatz

375 .00

(Charge for tapping permit to supply water service to) Lot No. 22

Sub Div. Gerken Hoeffel

Street No. 1106 Westchester Tap Size 1"

Cost \$ 375 .00

Plumber Whitmer PTH

Date completed

Approved by

water distribution dept.

finance director

Name

Size of tap 1"

Date 7-29-91

Street and No. 1106 Westchester

Old Tap No.

New Tap No. 9134

Size and Kind of Main 6" A.C.

Location of Main 10' south of south curb

Depth of Main 4 1/2'

Distance from Hydrant/Valve 146' west of Hyd # 218

Distance to Curb Stop from Corp. 54'

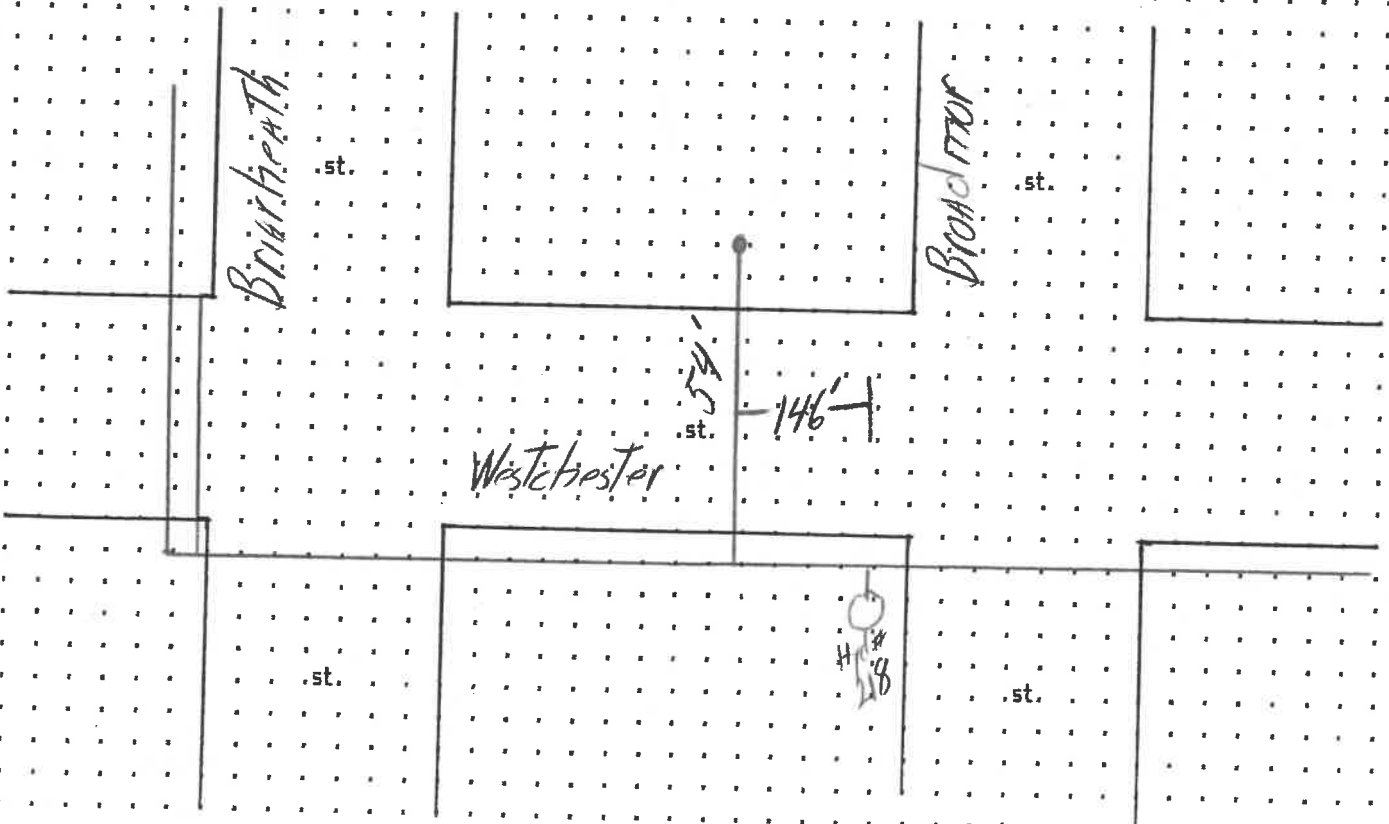



WATER TAPPING PERMIT

issued by

The Napoleon Water Distribution Department

255 West Riverview Ave. Napoleon, Ohio 43545 Pn. 592-4010

Entry No.

Permit No. ~~W-3813~~

Issued

7-22-91

Received of

Phil Bantz

(\$375).00

(Charge for tapping permit to supply water service to) Lot No.

22

Sub Div.

Carl Ken Heffel

Street No.

1106 W. T. H.

Tap Size

1"

Cost \$

375

.00 Plumber

Wp. Tracer P.H.

Date completed

Approved by

water distribution dept.

finance director

Name

Size of tap

Date

Street and No.

Old Tap No.

New Tap No.

Size and Kind of Main

Location of Main

Depth of Main

Distance from Hydrant/Valve

Distance to Curb Stop from Corp.

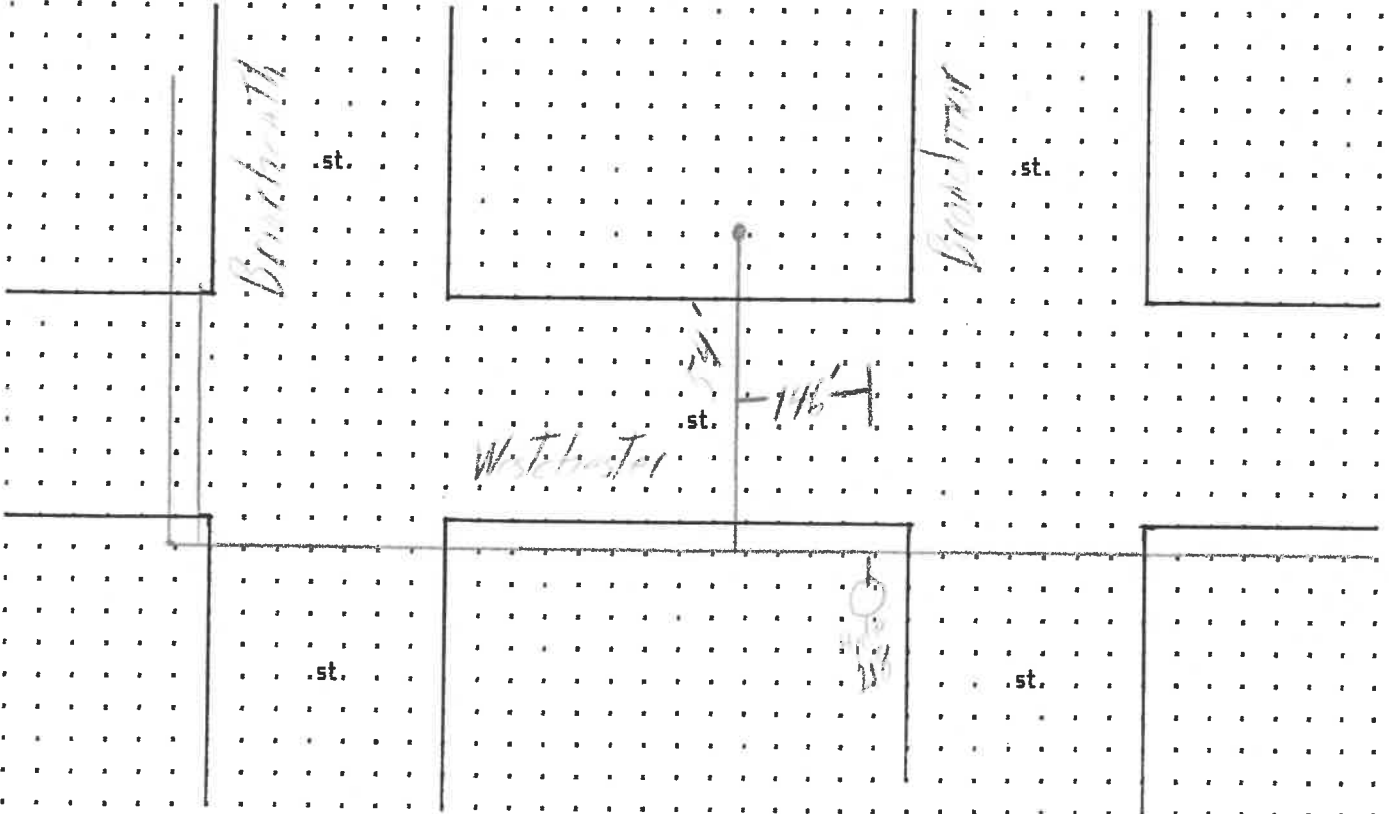



PERMIT

CITY OF NAPOLEON - BUILDING DEPARTMENT
 255 West Riverview Avenue, Napoleon, Ohio 43545 - 419-592-4010

Permit No. 02373 Issued 7-12-91
date

Job Location 1106 Westchester
address

Lot 22 Gerken & Hoeffel
sub-div or legal discript

Issued By Brent N. Damman
building official

Owner Phil Baatz 592-1596
name tel.

Address 230 Northcrest Ln., Apt. 21

Agent Self
builder-eng.-etc. tel.

Address _____

Description of Use Residential

Residential 1
no. dwelling units

Commercial _____ Industrial _____

New ~~xxx~~ Add'n. _____ Alter _____ Remodel _____

Mixed Occupancy _____

Change of Occupancy _____

Estimated Cost \$ 75,500.00

FEES	BASE	PLUS	TOTAL
<input type="checkbox"/> BUILDING			
<input type="checkbox"/> ELECTRICAL			
<input type="checkbox"/> PLUMBING			
<input type="checkbox"/> MECHANICAL			
<input type="checkbox"/> DEMOLITION			
<input type="checkbox"/> ZONING			
<input type="checkbox"/> SIGN			
<input type="checkbox"/> WATER TAP			
SEW. INSP.			
SEWER TAP			
TEMP. WATER	\$5.00		\$ 5.00
TEMP. ELECT.	\$10.00		\$10.00
ADDITIONAL PLAN REVIEW	Struct. _____ hrs _____ Elect. _____ hrs _____		
TOTAL FEES.....			\$15.00
LESS MIN. FEES PAID <u>7-12-91</u> <small>date</small>			15.00
BALANCE DUE.....			\$ 0.00

ZONING INFORMATION

district A	lot dimensions 80.14 x 105.14	area 8426	front yd 30'	side yds 7'	rear yd 15'
max hgt 35'	no pkg spaces 2 per	no ldg spaces	max cover 35%	petition or appeal req'd	date appr

WORK INFORMATION:

Size: Length _____ Width _____ Stories _____ Ground Floor Area _____

Height _____ Building Volume (for demo. permit) _____ cu. ft.

Electrical: _____
brief description

Plumbing: _____
brief description

Mechanical: _____
brief description

Sign: _____ Dimensions _____ Sign Area _____

Additional Information: New home construction

PAID

JUL 12 1991
 CITY OF NAPOLEON

Date 7/12/91 Applicant Signature [Signature]
owner-agent

INSPECTION RECORD

	UNDERGROUND			ROUGH-IN						FINAL		
	Type	Date	By	Type	Date	By	Type	Date	By	Type	Date	
PLUMBING	Building Drains			Drainage, Waste & Vent Piping			Indirect Waste			Drainage, Waste & Vent Piping		
	Water Piping									Backflow Prevention		
	Building Sewer			Water Piping			Condensate Lines			Water Heater		
	Sewer Connection									FINAL APPROVAL		
MECHANICAL	Refrigerant Piping			Refrigerant Piping			Chimney(s)			Grease Exhaust System		
				Duct Furnace(s)			Fire Dampers			Air Cond. Unit(s)		
	Ducts/Plenums			Ducts/Plenums			<input type="checkbox"/> Radiant Htr(s) <input type="checkbox"/> Unit Htr(s)			Refrigeration Equipment		
				Duct Insulation			Pool Heater			Furnace(s)		
			Combustion Products Vents			Ventilation <input type="checkbox"/> Supply <input type="checkbox"/> Exhst.				FINAL APPROVAL		
ELECTRICAL	Conduits & or Cable			Conduits/Cable			<input type="checkbox"/> Range <input type="checkbox"/> Dryer			Temp Service Temp Lighting		
	Grounding & or Bonding			Rough Wiring			<input type="checkbox"/> Generator(s) <input type="checkbox"/> Motors			Fixtures Lampholders		
	Floor Ducts Raceways			Service Panel Switchboard			<input type="checkbox"/> Water Htr <input type="checkbox"/> Welder			Signs		
	Service Conduit			Busways Ducts			<input type="checkbox"/> Heaters <input type="checkbox"/> Heat Cable			Electric Mtr. Clearance		
	Temporary Power Pole			Subpanels			<input type="checkbox"/> Duct Htr(s) <input type="checkbox"/> Furnace(s)			FINAL APPROVAL		
BUILDING	Location, Set-backs, Esmt(s)	7/25	BD	Exterior Wall Construction	8/30	BD	Roof Covering Roof Drainage			Smoke Detector	7/12	
	Excavation						Exterior Lath			Demolition (sewer cap)		
	Footings & Reinforcing	7/25	IP				<input type="checkbox"/> Interior Lath <input type="checkbox"/> Wallboard					
	Floor Slab			Interior Wall Construction	8/10	BD	Fire Wall(s)			Building or Structure	7/12	
	Foundation Walls	7/25	BD	Columns & Supports			Fireplace Chimney					
	Sub-soil Drain	7/25	BD	Crawl Space <input type="checkbox"/> Vent <input type="checkbox"/> Access	8/30	BD	Attic <input type="checkbox"/> Vent <input type="checkbox"/> Access					
	Piles			Floor System(s)	8/30	BD				FINAL APPROVAL BLDG. DEPT.		
			Roof System			Special Insp Reports Rec'd			Certificate of Occupancy Issued			
ADDITIONAL	INSPECTIONS, CORRECTIONS, ETC.						INSPECTIONS, CORRECTIONS, ETC.					
	PAID						Low grading west side improper. Issue temp occupancy. ONLY					

CITY OF NAPOLEON INSPECTION FORM

PERMIT #: 97122

DATE ISSUED: 04-29-97

JOB LOCATION: 1106 WESTCHESTER AVE

OWNER: BAATZ, PHILIP

OWNER PHONE: 419-592-4823

CONTRACTOR: SELF

CONTRACTOR PHONE:

WORK DESCRIPTION: WOOD FENCE ADDITION

PLUMBING:

UNDGR

RGHIN

FINAL

SEWER INSP

MECHANICAL:

UNDGR

RGHIN

FINAL

FURNACE REPLC

AIR COND

ELECTRICAL:

UNDGR

RGHIN

FINAL

SERV UPGR

BUILDING:

SITE

FTG

FNDT

STRUC

ROOF

EXT

VENT

ACCES

EGRS

SMKDT

FINAL

ISSUE TEMP OCCUP

ISSUE OCCUP

STRG SHED: SITE

FINAL

SIGN:

FTG

FINAL

FENCE:

SITE

FINAL

5-7-97

MISC INSP:

NOTES:

INSPECTOR INITIALS:

1100 WESTCHESTER AVE.

PERMIT #97122

PHILIP BARTZ

\$2,500

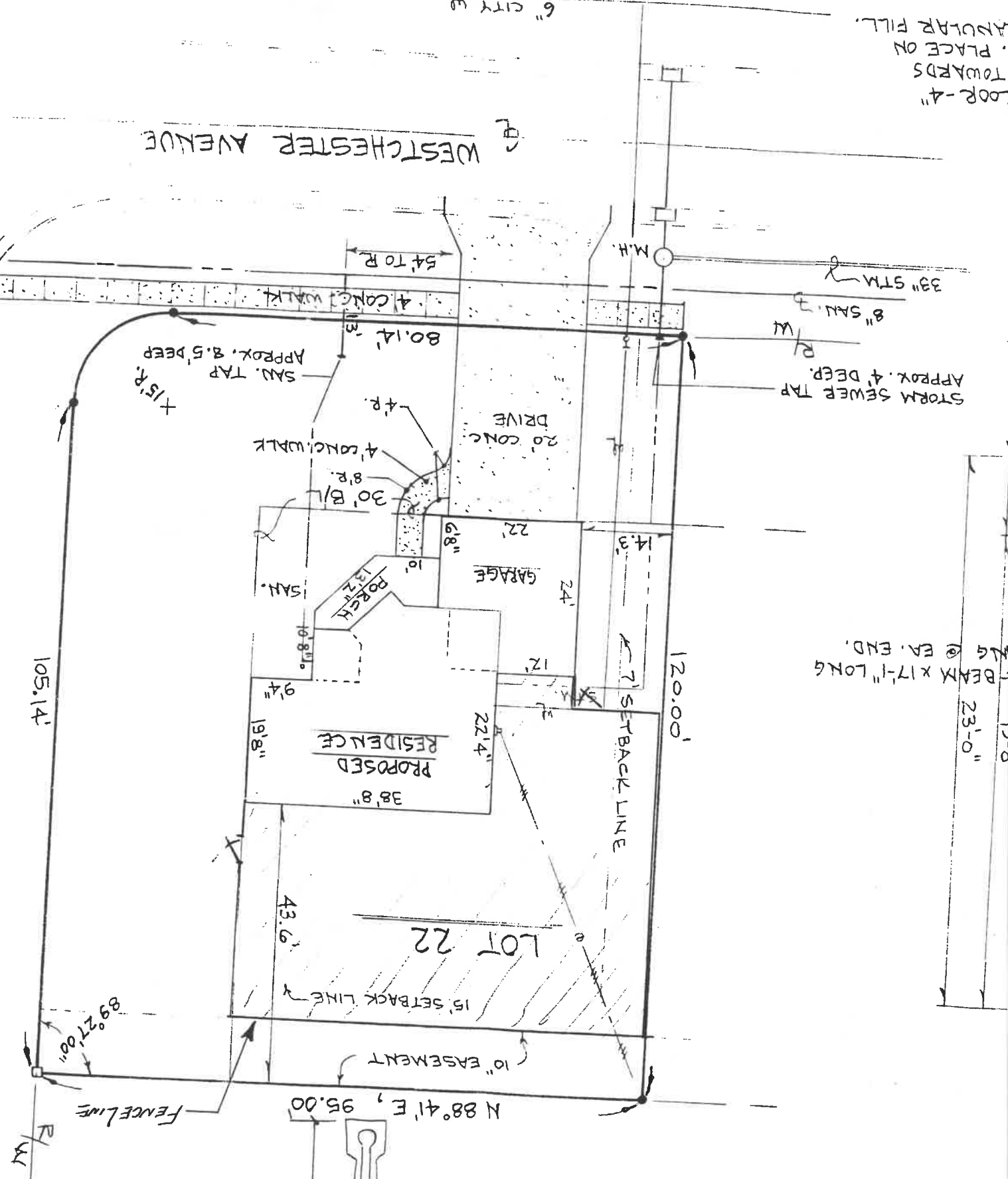
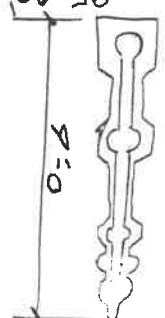

12'-0"
23'-0"
W.G. @ EA. END.
-BEAM X 17'-1" LONG

LOOK-4"
TOWARDS
PLACE ON
ANGULAR FILL.

ZONING PERMIT

Zoning Permit No. 0009

Issued 7-11-91

By Brent N Damman
Zoning Inspector

Issued To: Eugenia Gerken

Lot Information: % Eugene Gerken 900 W. Riverview Filing Fee 5.00
Amount Date Paid

Street Address 1105 + 1106 Westchester

Lot No. 21+22 Subdivision Gerken Hoettel 2nd.
(or Legal Description)
1 @ 95' x 104'

Lot Dimensions 1 @ 95' x 105' Yard Set Back: Front 30' Rear 15'

Lot Area N/A Sq. Ft. Side 7' Side 7'

Zoning District A-~~residential~~ Description of Use Residential

Lot Coverage max. 25% Off Street Parking Spaces Required 2 per

Height 35' Loading Spaces Required _____

Petition or Appeal Required _____

Approved By: Zoning Inspector Hearing # 9/1/91 Board of Zoning Appeals approved 5/14/91
to reduce front setbacks to Broadmoor Ave. from 30'-20'

Date _____ Applicant Signature _____

Owner-Agent

White - Applicant

Pink - Engineering

Yellow - Board of Zoning Appeals

Phil Bantz

6-28-91

1106 Westchester
Whitman Pkwy.

